



FICHA TECNICA / DATA SHEET

Medios Redondos / Semi Half

Medios Redondos

Acero semirredondo laminado en caliente: Kg/m

Hot rolled semi-round steel: Kg/m

Calidad / Quality: S275JR / S355J2

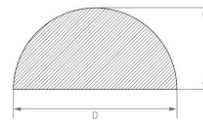

mm	Kg/m
40 x 20	4.93
50 x 25	7.70
60 x 30	11.10
70 x 35	15.30

